

1 0 1 0 2
3 0 0 4
a-L-b (+)

SPST
CONTACT CONFIGURATION

NOTES:

1. ALL DIMENSIONS IN MM
2. GENERAL TOLERANCE: X.X=±0.4
X.XX=±0.25
3. RATINGS: 5A @250V AC
8A @125V AC
4. CONTACT MATERIAL:
COPPER ALLOY W/Silver Plating
5. LAMP VOLTAGE: 28V AC/DC 40ma

| PARTS LIST | | | |
|------------|------|----------|----------------------------------|
| ITEM | QTY. | PART NO. | PART DESCRIPTION |
| 1 | 1 | F040005 | D16 EE S1 1 |
| 2 | 1 | F050405 | 50-004-05 (Incandescent bulb) |
| 3 | 1 | F050303 | 50-003-03 (Transparent ORG lens) |

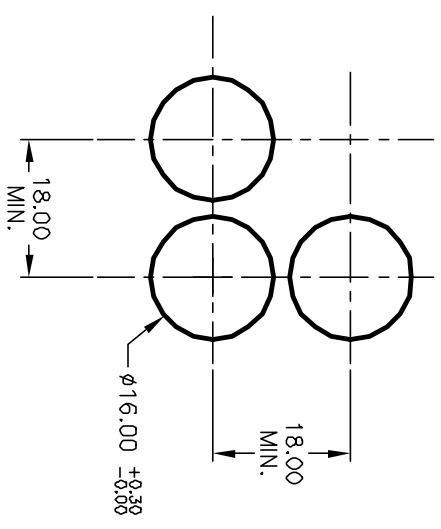

RECOMMENDED PANEL MOUNTING
SCALE 1:1

| REV. | ECN No. | DESCRIPTION | DATE | CHKD |
|------|---------|-------------------------|----------|------|
| A | 12503 | RELEASED FOR PRODUCTION | 10/21/02 | CJB |

| TITLE | SCALE | DATE | DR | DWG | REV |
|--|-------|----------|----|---------|-----|
| D16 EE S11 C DRG (La tching) TRANSPARENT/CONCAVE LENS | 1.5:1 | 10/21/02 | CB | XF0524P | A |

E-SWITCH®

THE INFORMATION CONTAINED IN THIS DOCUMENT IS PROPRIETARY TO E-SWITCH AND IS NOT TO BE COPIED OR TRANSFERRED